

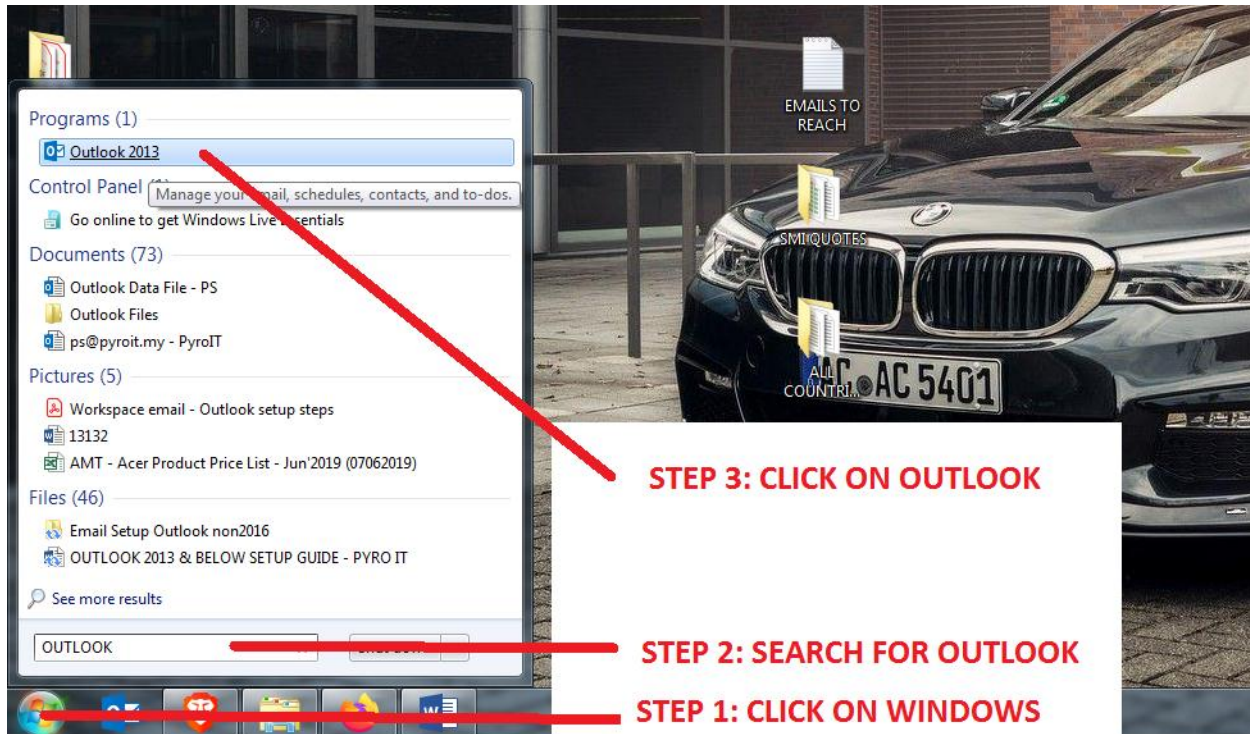

PYRO IT (M) SDN. BHD.
Innovation and Excellence

Unit 1, Ground Floor, Crown House,
Crystal Crown Hotel,
No. 217, Persiaran Raja Muda Musa
42000 Port Klang Selangor Darul Ehsan
☎ +6017 262 5004
✉ info@pyroit.my

EMAIL SETUP



How to Setup Email on Outlook when you already have emails setup

1. Click on File
2. Below the current email, add account
3. On the popup, select manual setup, click next
4. Click on pop or imap, click next
5. Change Account Type IMAP – if synchronization required (SAME EMAIL USED BY FEW DEVICE / PPL)
POP3 – if not required (THEIR SERVER VERY SMALL)
6. Add Name, email address, select account type,
7. incoming & outgoing mail server will match email name
For example – ps@pyroit.my
Mail server – mail.pyroit.my (for both incoming/outgoing)
8. User Name – Email Address
9. Password – As per theirs
10. click on more settings.



PYRO IT (M) SDN. BHD.
Innovation and Excellence

Unit 1, Ground Floor, Crown House,
Crystal Crown Hotel,
No. 217, Persiaran Raja Muda Musa
42000 Port Klang Selangor Darul Ehsan
☎ +6017 262 5004
✉ info@pyroit.my

11. Go to advanced – use defaults , IF IT DOESN'T WORK CHOOSE SSL

INCOMING PORT – SSL (PORT AUTO SELECTS)

IMAP – 143 / 993 (SSL)

POP3 – 110 / 995 (SSL)

OUTGOING PORT – SSL – 465 / 587 / 25 / 26 / 2525

12. ON Outgoing section, click on MY OUTGOING SERVER (SMTP) requires authentication

